



READ CAREFULLY!

Prior to using your Halo series device, it is highly recommended that you thoroughly peruse the instruction booklet provided.

Doing so will enable you to optimize your experience with the product and mitigate the risk of any potential damage or operational disruptions, thereby emphasizing the importance of taking this precautionary step as soon as possible.

Check www.zeepor.com
for more support or helpful tips.

WHAT IS THIS MANUAL INCLUDED

- Packing list / *P 03*
- What is the feature? / *P 04*
- Technical data / *P 05*
- How to use? / *P 06-10*
- Battery charging / *P 11*
- Light Effect / *P 12*
- Safety tips / *P 16*
- Trouble shouting & Warranty / *P17*

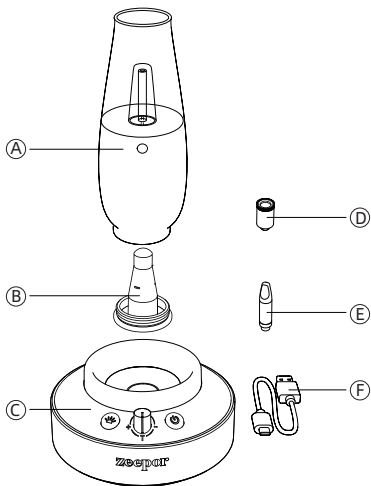

A:Glass cup

C:Vaporizer base

E.:510 cartridge

B:Silicone rubber

D:Ceramic chamber

F:USB C cable

WHAT IS THE FEATURE?



Enjoy your social sharing
with friends freely



4000mah big capacity
battery to support



3 in 1, work with
dry herb, wax and oil



Fits with 510 cartridges and
ceramic chamber



4 different mode light setting



Mechanical button design
easy to use



Stepless temperature control

TECHNICAL DATA

Compatibility: dry herb & concentrate

Heating element: ceramic chamber or 510 carts

Heat up time: 30 seconds

Heating method: Convection

Battery capacity: 4000mah

Charging time: 1.5-2 hours

Standby time: 20h. fill up 300 cups

Hola cup capacity: 400ml

Ceramic chamber capacity: 0.45ml

510 cartridge: 1ml

Color option: Brown & Purple

Lighting mode:  Blue(Calm mode)

 Green(Herb mode)

 Red(Blaze mode)

 Dark(Stealth mode)

Temperature: 150 °C--300 °C, 300°F--600°F

300°F	350°F	400°F	450°F	500°F	550°F	600°F
149°C	177°C	205°C	232°C	260°C	288°C	315°C

Warranty: 1 year

Packing info:

Product size: 126mm*67mm

Box size:27.5*23.5*9cm

Box weight: 0.85kg

Packing list: Vaporizer base, glass cup, USB cable, 510 carts, ceramic chamber, manual guide, gift box

HOW TO USE?

1

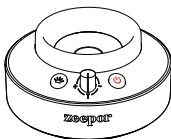

Take out the vaporizer base
out of the box

2

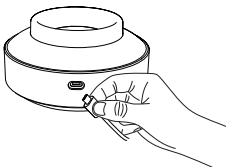

Fully charge device before first use.
When red light flashing,
means battery is low

3

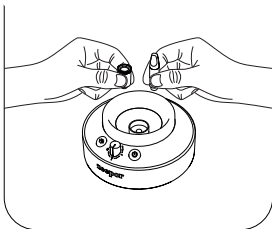

Screw the 510 cartridges or ceramic chamber on the base

4

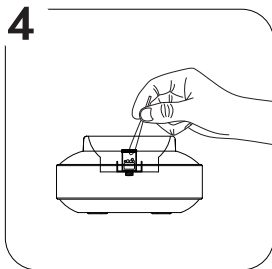

Fill in the chamber with concentrate or dry herb

5

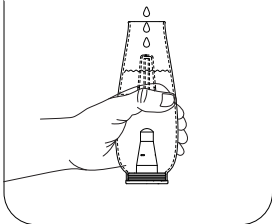

Fill the cup with beverage or water

6

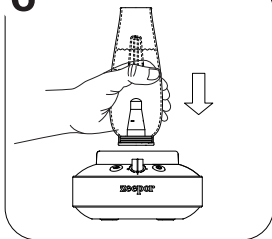

Carefully put glass cup on the
vaporizer base

7

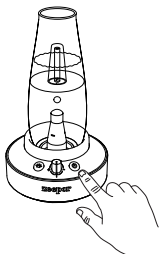

Turn on the device

8

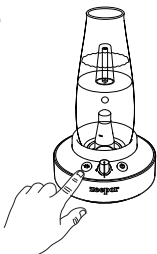

Turn on the light button

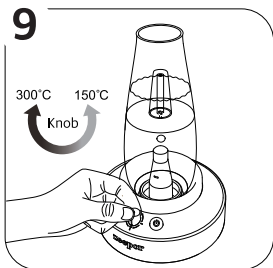

Adjust the knob to discover the optimal temperature for your vaping experience.

This device is equipped with unlimited temperature control, enabling you to customize the temperature to your preferences and requirements, resulting in the most satisfying flavor.

BATTERY CHARGING

1. When the power button flashes red, it indicates that the battery is low and needs to be charged.
2. The standard charging cable has a USB port that can be used with a regular phone adapter. The other end, which is Type-C, should be plugged into the host device for charging.
3. During charging, the power button's red light will have a breathing effect, and when the battery is fully charged, the red light will remain on.
4. Please unplug the USB charging cable after the device has finished charging.

Battery information:

1. The product has a built-in lithium-ion battery that cannot be removed.
2. It can be charged and discharged 500 times, but as the number of uses increases, the battery life will decrease.
3. If the device is not used for a long time, it is recommended to charge it for one hour each month to extend the battery life.

LIGHT EFFECT

Our device enjoy 4 different breathing light, click light button to switch different mode to enjoy your session.

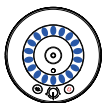

Blue
Calm mode

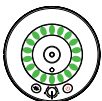

Green
Herb mode



Red
Blaze mode



Sesh mode
Discreet mode

10

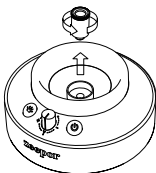

Detach the vaporizer chamber from the base. ⚠️ Be careful not to burn yourself

11

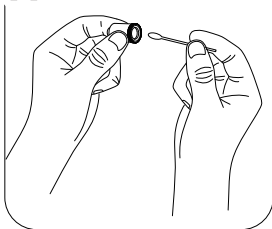

Take a cotton swab dipped in alcohol to wipe the vape chamber

12

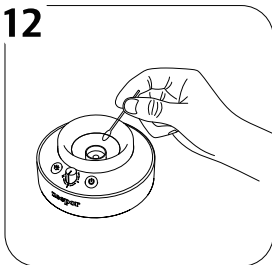

Use the cotton swab to clean vaporizer base

13

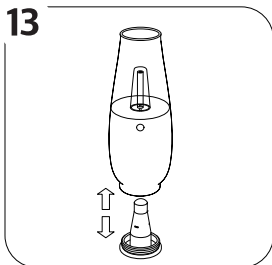

Remove the rubber from the glass container

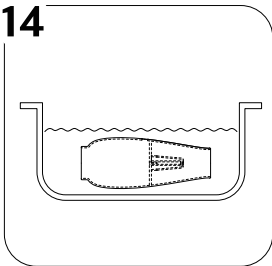
14

Soak the glass cup in alcohol

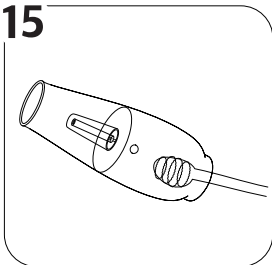
15

Use brush to clean inside of the glass cup

After cleaning, allow the device to air dry for 30 minutes before reassembling.

It is recommended to clean the device on a weekly basis. However, if you use it frequently, we advise cleaning it after each use.

SAFETY TIPS

- ❶ Wait till the chamber cool down then take it off.
- ❷ Don't drop water on the base, if there is, please clean it ASAP.
- ❸ For the filter cup, dont fill the water over the max line.
- ❹ Dont store device with water in the glass
- ❺ Attach/detach glass carefully, do not force
- ❻ Several short inhales produce more vapor
- ❼ Do not place contents on the sidewalls of the bowl.
- ❽ Do not overfill chamber
- ❾ Keep away from etreme hot and cold temperature
- ❿ Keep away from moisture and high humidity.
- ⓫ Should the issues persist, contact support team.

Trouble shouting

If there is no mist coming out, please make sure the battery is fully charged.

Or check if the chamber is screwed tightly.

Warranty

We offer 1 year guarantee after each utilization. Zeepor gives one year of inclusion to just the electronic base.

This covers in workmanship for one year from the date of unique retail buy.

Zeepor doesn't warrant glass, atomizers, typical mileage, or harm brought about coincidentally or misuse.

To acquire administration, email Zeepor customer care at info@zeepor.com

Dependent upon the full terms and nitty gritty data recorded on Zeepor's site under nearby buyer regulations.

You might be expected to outfit evidence of procurement subtleties, and the actual gadget while making a case under this guarantee.

Try not to endeavor to open the Zeepor vaporizer base, this will quickly void the guarantee for your item.



zeepor[®]